

Paul Gauguin
CRUISES

THE PACIFIC ISLANDS
2024

FRENCH POLYNESIA • COOK ISLANDS • FIJI • TONGA

Celebrating
25
YEARS IN
French Polynesia

An aerial photograph of a tropical lagoon with clear, turquoise water. The water is shallow, revealing a sandy bottom and numerous dark, rocky patches. In the lower center, a large, circular thatched hut made of palm fronds sits in the water. To the left of the hut, a person is swimming. The overall scene is serene and idyllic.

Ma eva

Welcome, in Tahitian



la ora na

It often begins with 'Hello'. An everyday hello probably doesn't mean much but, when said at a key moment, it can change all kinds of things. Imagine the following: you've just arrived at Papeete. It has been a long voyage. The first words you hear are 'Maeva' and 'la ora na', spoken warmly with a smile, the 'r' rolled. Now you're there. The words 'welcome' and 'hello' are at the very heart of Polynesian hospitality.

They herald the start of a voyage marked by friendly conviviality and will precede every encounter you have with the local people on land, with the ship's crew, and with the *Gauguins* and the *Gauguines*: the hosts present by your side throughout your stay on board.

Having become part of the PONANT family in 2019 and now celebrating 25 years in Polynesia, *Le Paul Gauguin* distils the typically relaxed, international atmosphere offered by the company into an ambiance decidedly different from that of the other ships in the fleet.

Designed especially for the shallow waters of the South Pacific, *Le Paul Gauguin* also has its own particular adeptness to offer. It takes you, gently and smoothly, from the Society Islands to Fiji via the Tuamotu Archipelago and the Marquesas. Each port of call brings out your *mana*, that special aura given off by every being, every element. The scenery and surroundings play a large part in this. The private island of *motu* Mahana, idyllic beaches, countless lagoons, seabeds teeming with life, wild jungles, dizzying peaks – as the days pass, a veritable mosaic comprised of thousands of shades of green and blue fills and permeates you, bringing serenity. "C'est que du bonheur!" – it's nothing but joy – little by little, the mantra of this unique region takes on its full meaning. Ready for the voyage?

Happy reading,

Hervé Gastinel
PONANT CEO





Summary

Explore the South Pacific on board <i>Le Paul Gauguin</i>	6
6 reasons to sail with Paul Gauguin Cruises	8
Life on board	10
The itineraries	12
Welcome aboard	20
Formalities	27



Explore the South Pacific aboard *Le Paul Gauguin*

Shades of blue and green come to life in the lagoons, the beaches, the forests, the mountainous landscapes, and the ocean where the protective barrier reef embraces the teeming marine life. Now all that remains is to associate these images with the names that whisper through your heart.



International date line



Get a real feel

Experience Polynesia, the South Pacific and all our destinations as if you were actually there!



Highlights



UNESCO sites



Diving



Private beach



Private motu (islet)



Tiki



Arts and crafts



6 reasons to sail with Paul Gauguin Cruises

1 A regional expert

One hundred and thirty years ago, the painter Paul Gauguin settled in Tahiti in search of a "sky without winter". Celebrating 25 years in 2023, the ship named in his honour and designed to navigate the shallow waters of the South Pacific has taken guests on a discovery of this far away part of the world where time seems to stand still. Wild islands cut by tormented reliefs, deep valleys, lush jungles, precious lagoons and secluded coves... Each moment on board *Le Paul Gauguin* promises a unique way of exploring the region.

2 Unprecedented routes

All *Le Paul Gauguin* itineraries have been designed to offer you an authentic experience of Polynesia and the islands of the South Pacific. Tahiti, Moorea, Bora Bora, the Tuamotus, the Marquesas, the Cook Islands, Fiji and Tonga: lasting from 7 to 14 nights, our trips offer you both a first discovery of these enchanting islands and time to get to know the South Pacific, its cultures and traditions. The many excursions and activities offered on each stopover ensure you don't miss out on anything in this unique environment.

3 A ship with the personal touch

Le Paul Gauguin has 165 staterooms and suites, each offering its own view of the incredible surroundings. To make sure you enjoy your trip with complete peace of mind, the ship has 1.5 crew members per guest, one of the best ratios in the cruise industry. The service is therefore very attentive and contributes to the warm on-board atmosphere.

4 More sustainable tourism

We have made many commitments in the pursuit of more responsible tourism. Here are a few of them:

- To consider the whole world to be a "zone with controlled sulphur oxide emissions" since 2019 and "nitrogen" by 2025.
- To reduce CO₂ emissions by 15% by 2026 and 30% by 2030 compared to 2019 levels.
- To be a driving force alongside the Blue Nature Alliance to create 18 million km² of protected marine areas by 2025.
- To ensure the re-use of 80% of waste by 2026.
- To completely eliminate single-use plastic by 2022.

5 An all-inclusive experience

Taking advantage of an all-inclusive offer means you can relax completely and enjoy your holiday to the full. Meals and snacks, a wide selection of drinks, room service, butler service for certain suites and staterooms, nautical equipment (masks and snorkels, stand-up paddleboards), entertainment and exclusive access to a private beach and a private islet are thus included in the price of your voyage.

6 A unique aura, the *mana*

Idyllic landscapes, earthly paradises, thousand-year-old culture, bewitching dances... Open yourself up to the *mana*, the sacred force of Polynesia, which permeates all decks of the ship, while in the surroundings of sumptuous decor, guided by our joyous *Gauguines* and *Gauguins* Polynesian hosts. *Mana* is an almost palpable force that breathes its magic into your voyage.

A complete package



The Polynesian art of living, the relaxed atmosphere, attentive service, gourmet dining, activities: allow yourself to be carried between moments of relaxation, adventure and discovery, thanks to all the services included and reserved for you on board.

- All-inclusive from arrival to departure
- Catering at all hours of the day: tea and sweet treats, aperitifs, appetisers...
- A selection of drinks in restaurants, bars and minibars
- 24-hour room service
- Butler service in some suites and staterooms
- Free and unlimited Wi-Fi service on board
- Onboard gratuities for room stewards, dining and bar staff
- Special evenings, shows and other activities
- The support of the *Gauguines* and *Gauguins* Polynesian hosts
- Lectures delivered by experts of the area
- Access to the fitness centre and steam room
- From the marina access point, various non-motorised nautical leisure activities, such as kayaking and paddleboarding
- The free rental of masks and snorkels
- Access to a private beach on Bora Bora and to *motu Mahana*
- Shuttle service to Huahine
- All port and security fees

Butler service is available for the following suites: Owner's Suites, Grand Suites, A Veranda Suites and B Veranda Staterooms. Please note that the Wi-Fi connection may be slow and possibly interrupted depending on the geographical area or in circumstances beyond our control. Access to the steam room can be limited or unavailable due to health restrictions. Scuba diving and excursions are charged extra.

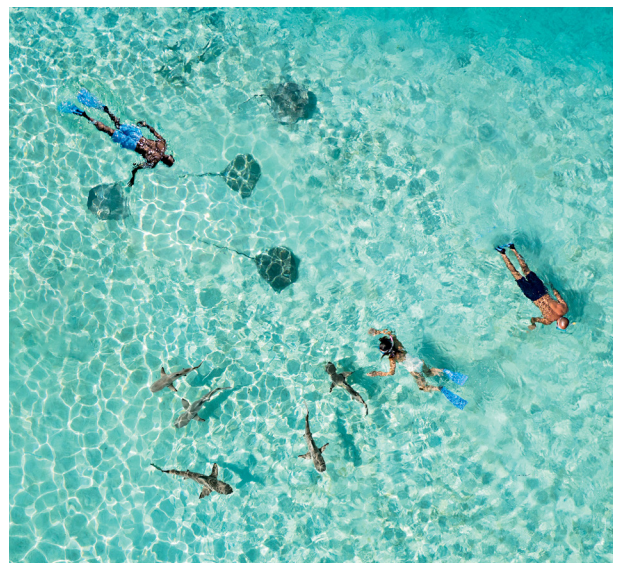

Children and teens in the spotlight



In partnership with *Te mana o te moana*, a South Pacific marine education and conservation foundation, the Moana Explorer Program invites children and teens, ages 7-15, to discover and value the natural wonders of this breathtaking part of the world through hands-on, interactive learning. Every day of the voyage, there is a combination of excursions, science activities, crafts and other adventures. Depending on the itinerary, children might learn about underwater life, create natural jewellery, conduct water experiments, go on a treasure hunt, enjoy water games in the on board pool, or design their own Polynesian artwork. Best of all, there is no fee* for this special family program! It's all part of PAUL GAUGUIN Cruises' extraordinary all-inclusive value.

**Moana Explorer Program is available only on selected departures.*



Life on board

On board, the relaxed, international atmosphere, friendliness and attentive service make every moment memorable.



The *Gaugines* and *Gauguins*, our Polynesian hosts, will be with you every day from the moment you arrive on board. There are songs, cultural exchanges, pareo knotting and wreath weaving workshops, Polynesian dance classes and more. You will be able to enjoy an authentic immersion in this rich culture through interaction with them.

Blending in with the surrounding scenery, the pool is ideal for long periods of relaxation and contemplation.



Our specially designed marina platform turns the ship into your playground for all kinds of adventures on the water. It's as easy as descending to sea level and hopping aboard a paddleboard or launching a kayak.

The Deep Nature spa offers a wide choice of massages and Algoterm treatments, based on marine cosmetics. The fitness room offers the full range of machines and weight training equipment needed to stay in shape.



The shop features a collection of gift items, clothing, and jewellery made with Tahitian pearls.

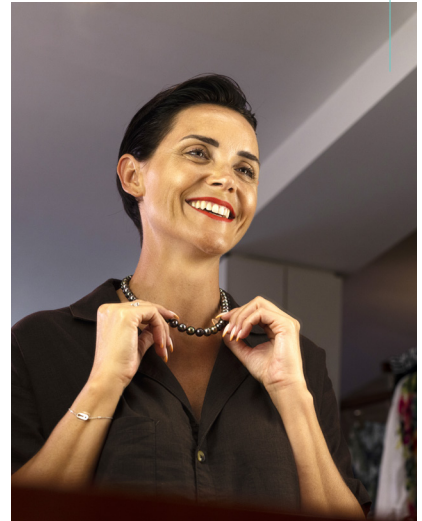

Near the restaurant L'Étoile, the piano bar provides a lounge atmosphere with performances by the pianist on board. This is the perfect opportunity to relax before or after your meal.



There is entertainment on board every day, including local artists invited on board, piano concerts and dance evenings. The pleasure of the discoveries made on land continues with engaging lectures given by the experts who accompany you during your trip.

Tahiti & the Society Islands



Papeete • Papeete

8 days/7 nights | From AU\$6,300 per person twin share ⁽¹⁾
6th April, 22nd June, 27th July, 7th September, 19th October
and 23rd November 2024

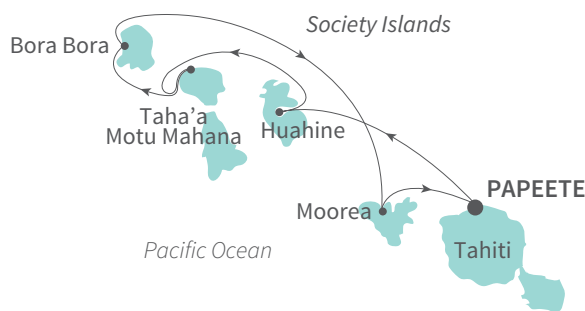

Highlights

- **Live the exceptional:** a voyage of initiation into the wonders of the natural treasures and ancient traditions of the Society Islands.
- Slow down and let stress float away on secluded Huahine: explore the village on foot; wander through lush rainforests; float in crystal-clear lagoons.
- Experience a memorable day on *motu* Mahana, our own private slice of paradise: treat yourself to sand between your toes and a sumptuous barbecue lunch.
- Enjoy an overnight in exquisite Bora Bora and explore its dramatic mountain peaks, romantic lagoon and impossibly turquoise waters.
- Two days on Moorea exploring all the riches its ancient heritage and spectacular scenery have to offer, from the hillside pineapple plantations to the Belvedere lookout, from where you can admire the bays of Cook, Ōpūnohu and Rōtui.
- Discover Polynesia's customs and traditional way of life.
- Landscapes: lagoons, idyllic beaches, deserted coves, tropical forests and mountain peaks.
- Possibility of diving (PADI Open Water Diver or equivalent).



To view all the shore excursions,
scan the QR code or click [HERE](#)





Opposite: private beach for cruise guests in Bora Bora.

Pearls of the Society Islands



Papeete • Papeete

8 days/7 nights | AU\$6,300 per person twin share⁽²⁾
17th February, 4th May, 29th June, 20th July and 17th August 2024

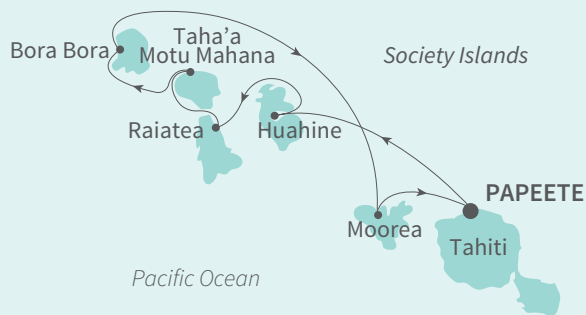

On this itinerary, you get to enjoy a full day on Raiatea (which replaces one of the two days on Moorea on the **Tahiti & the Society Islands** itinerary). According to legend, the island is the cradle of the gods because it is home to the earliest traces of local human habitation as well as the oldest place of worship in Polynesia – namely the Taputapuātea marae, a UNESCO World Heritage Site. This platform was once a highly important political, ceremonial and funerary centre. The island also has a wonderful range of nature and wildlife to reveal to the curious who come to explore it.



Taputapuātea marae, Raiatea.

Society Islands & the Tuamotus



Papeete • Papeete

11 days/10 nights | From AU\$8,110 per person twin share⁽³⁾
24th January, 6th March, 24th April, 29th May, 9th October
and 11th December 2024

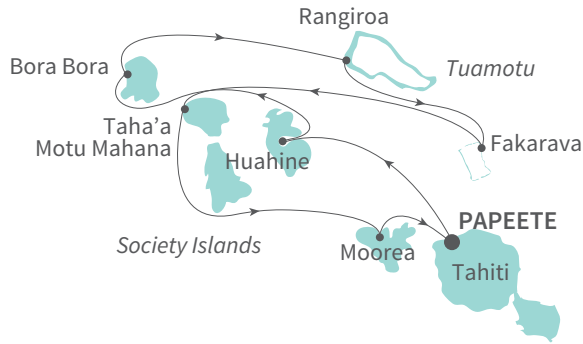

Highlights

- **Live the exceptional:** two days on the Tuamotu Archipelago, with its atolls teeming with life, its rare species of birds and plants, and its black pearl farms.
- UNESCO World Heritage Site: Fakarava, a biosphere reserve and the world's second-largest lagoon, home to unique flora and fauna, grey sharks and untouched coral reefs.
- Enjoy an overnight in exquisite Bora Bora and explore its dramatic mountain peaks, romantic lagoon and impossibly turquoise waters.
- Discover the 'infinite lagoon' on Rangiroa, the biggest atoll in French Polynesia, which is famous for its 'wall of sharks'.
- Experience a memorable day on *motu* Mahana, our own private slice of paradise: treat yourself to sand between your toes and a sumptuous barbecue lunch.
- Discover Polynesia's culture and traditions, especially pearl farming in Rangiroa.
- Fauna: manta rays, spotted eagle rays, common eagle rays, lemon sharks, blacktip reef sharks, sea turtles and multicoloured fish.
- Possibility of diving (PADI Open Water Diver or equivalent).



To view all the shore excursions,
scan the QR code or click [HERE](#)





Cook Islands & Society Islands



Papeete • Papeete

12 days/11 nights | From AU\$8,560 per person twin share⁽⁴⁾
13th January, 24th February, 13th April, 18th May,
28th September and 30th November 2024

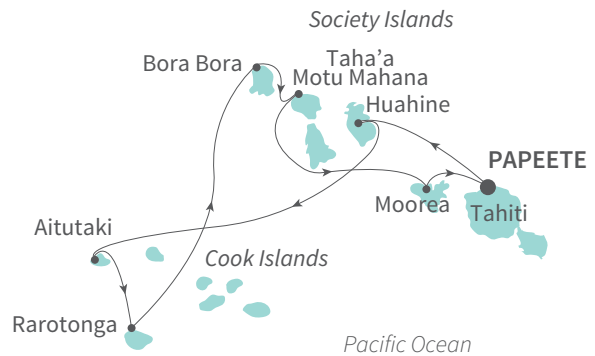

Highlights

- **Live the exceptional:** two days exploring the Cook Islands, with a port of call at Aitutaki, which is considered one of Polynesia's most beautiful islands and is famous for its hand-made *tivaevae*, a kind of quilt, and colourful pareos, which are produced on the island.
- Discover Rarotonga, its luxuriant Takuvaine Valley and its capital, Avarua, with the possibility of visiting the sacred and ancient site of Arai-Te-Tonga.
- Enjoy an overnight in exquisite Bora Bora and explore its dramatic mountain peaks, romantic lagoon and impossibly turquoise waters.
- Experience a memorable day on *motu* Mahana, our own private slice of paradise: treat yourself to sand between your toes and a sumptuous barbecue lunch.
- Explore Moorea, the 'magic island' that has inspired many artists with its eight valleys, 900-metre Mount Rōtui, beautiful bays and perfect lagoon.
- Fauna: lemon sharks, blacktip reef sharks, spotted eagle rays, manta rays, superb coral, sea turtles, giant green morays, emperor angelfish, Napoleon fish, butterflyfish...
- Possibility of diving (PADI Open Water Diver or equivalent).

To view all the shore excursions,
scan the QR code or click [HERE](#)



Marquesas, Tuamotus & Society Islands



Papeete • Papeete

15 days/14 nights | From AU\$11,640 per person twin share⁽⁵⁾
3rd February, 16th March and 21st December 2024

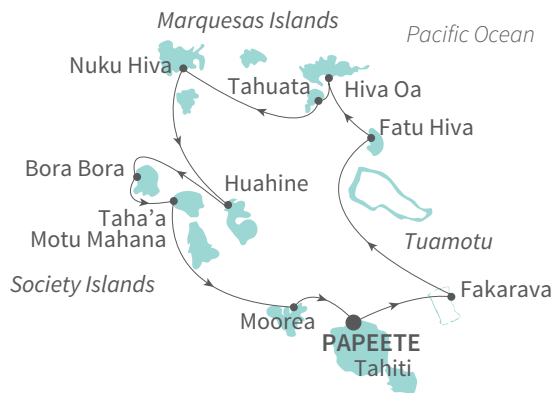

Highlights

- **Live the exceptional:** explore three of French Polynesia's archipelagos on the same voyage, including four days in the wild, unspoiled Marquesas Islands.
- UNESCO World Heritage Site: the biosphere reserve of Fakarava, the world's second-largest lagoon, home to unique flora and fauna, grey sharks and untouched coral reefs.
- History and culture are in the forefront on the island of Hiva Oa, home to the largest stone sculptures in the Marquesas, which are said to be linked to the famous *tiki* of Easter Island.
- Discover Polynesian culture: ancient crafts in Fatu Hiva, sculpted works in Tahuata, sculpted stone *tiki* and 7,000 petroglyphs in Taiohae (Nuku Hiva).
- The stops in secluded Huahine and superb Moorea, in the Society Islands.
- Experience a memorable day on *motu* Mahana, our own private slice of paradise: treat yourself to sand between your toes and a sumptuous barbecue lunch.
- Landscapes: towering peaks, imposing cliffs, plantations, forests, turquoise lagoons, unspoilt beaches, deserted coves, underwater caves, and more.
- Possibility of diving (PADI Open Water Diver or equivalent).



To view all the shore excursions,
scan the QR code or click [HERE](#)

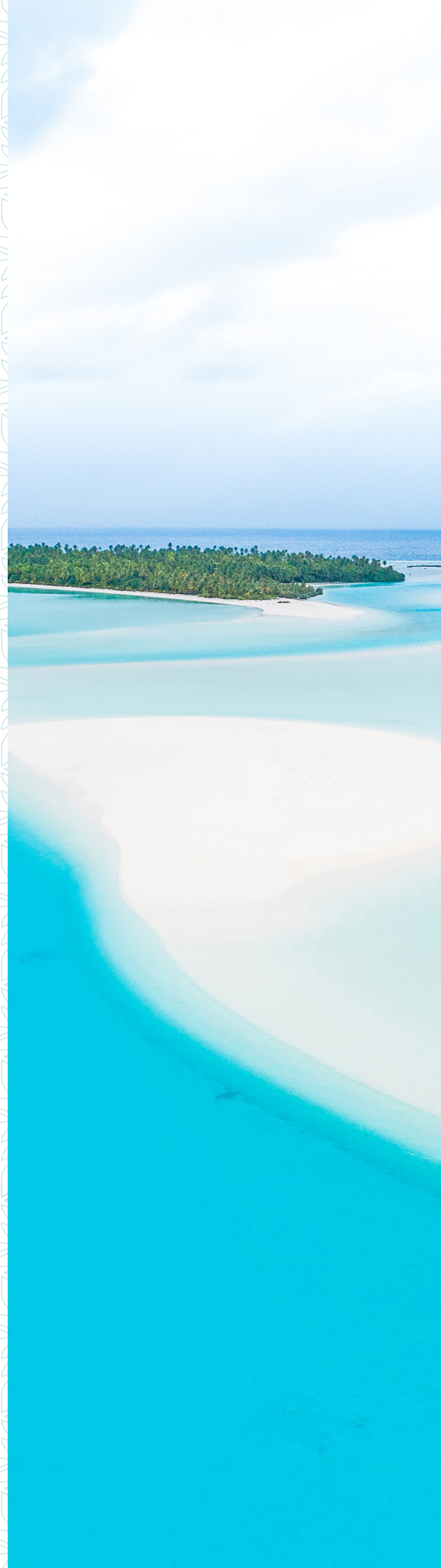



Marquesas in depth, Tuamotus & Society Islands



Papeete • Papeete

15 days/14 nights | From AU\$11,640 per person twin share⁽⁶⁾
8th June, 6th July, 3rd and 24th August,
and 14th September 2024

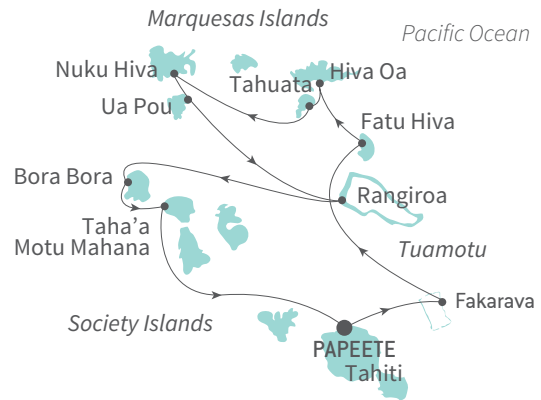

Highlights

- **Live the exceptional:** the ports of call in the Marquesas: Hatihe'u on the island of Nuku Hiva, with its superb valley, and Hakahau on the island of Ua Pou, one of the last of French Polynesia's islands to be explored. With a beach of black sand at its edge and its rocky volcanic pitons, the village offers an unsettling panorama.
- UNESCO World Heritage Site: the biosphere reserve of Fakarava, the world's second-largest lagoon, home to unique flora and fauna, grey sharks and untouched coral reefs.
- The stops in the idyllic atolls of Fakarava and Rangiroa, in the Tuamotus.
- History and culture are in the forefront on the island of Hiva Oa, home to the largest stone sculptures in the Marquesas, which are said to be linked to the famous *tiki* of Easter Island.
- Discover Polynesian culture: ancient crafts in Fatu Hiva, sculpted works in Tahuata, sculpted stone *tiki* and 7,000 petroglyphs in Taiohae (Nuku Hiva).
- Possibility of diving (PADI Open Water Diver or equivalent).

To view all the shore excursions,
scan the QR code or click [HERE](#)



Fiji, Tonga, Cook Islands & Society Islands



Papeete • Lautoka

15 days/14 nights | From AU\$10,890 per person twin share ⁽⁷⁾
26th October and 10th November* 2024

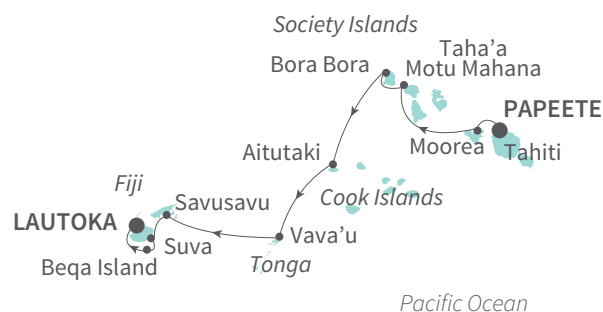

Highlights

- **Live the exceptional:** explore the coral islands of the Tonga archipelago and the islands of Fiji, with their traditional villages, reefs teeming with life, and wooded mountains.
- Two separate Fijian ports showcase an intriguing juxtaposition: the refined capital city of Suva and the unspoiled beauty of Savusavu, called the 'Hidden Paradise of Fiji'.
- The opportunity to explore local crafts in Tonga: the weaving of the leaves of the legendary pandanus, the production of noni juice, with its multiple beneficial properties, and the extraction of vanilla essence.
- Experience a memorable day on *motu* Mahana, our own private slice of paradise: treat yourself to sand between your toes and a sumptuous barbecue lunch.
- Crossing the International Date Line.
- Landscapes: superb atolls, transparent waters, turquoise lagoons, white-sand beaches, sugar cane and pineapple plantations, rocky peaks and more.
- Fauna: coral reefs, silvertip sharks, dolphins, sea turtles, common eagle rays, manta rays, ribbon eels, clownfish, colourful fish and more.
- Possibility of diving (PADI Open Water Diver or equivalent).

**Itinerary operates in reverse*

Centre: shores of the islands of Fiji.

Opposite: Intercontinental Hotel, Bora Bora.





Your pre and post voyage program

Choose the option that suits you best: a relaxing day with or without an overnight stay, taking advantage of the facilities and services offered in an amazing setting, or discovering the beauty of the area at your own pace. Our three-night programs will give you longer to savour the concentrated sense of wonder aroused by the splendours of Polynesia.*

<p>1 DAY before or after your voyage <i>(valid for all voyages)</i></p>	<p>A day room at the Intercontinental Tahiti</p>
<p>1 NIGHT before or after your voyage <i>(valid for all voyages)</i></p>	<p>One night at the Intercontinental Tahiti</p>
<p>3 NIGHTS before your voyage SOCIETY ISLANDS & TUAMOTUS</p>	<p>1 night in Papeete and 2 nights at the Hilton Moorea 1 night in Papeete and 2 nights at the Intercontinental Bora Bora</p>
<p>3 NIGHTS before your voyage <i>(valid for all voyages except for SOCIETY ISLANDS & TUAMOTUS)</i></p>	<p>3 nights at the Hilton Moorea 3 nights at the Intercontinental Bora Bora</p>
<p>3 NIGHTS after your voyage <i>(valid for all voyages)</i></p>	<p>3 nights at the Hilton Moorea and a day room in Papeete 3 nights at the Intercontinental Bora Bora and a day room in Papeete</p>

Prices: please contact us



*Pre and post voyage programs are subject to availability and may change at any time.

Welcome aboard





Length: 156 m

Width: 22 m

Draft: 5.15 m

Average cruising speed: 18 knots

Number of staterooms and suites: 165

Crew members: 209

Passenger Capacity: 330

Propulsion: diesel electric

Year of delivery: 1998, renovated in 2021

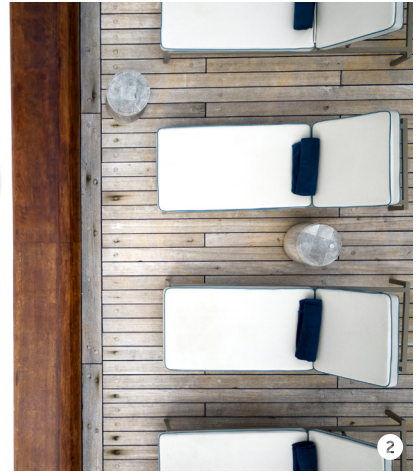
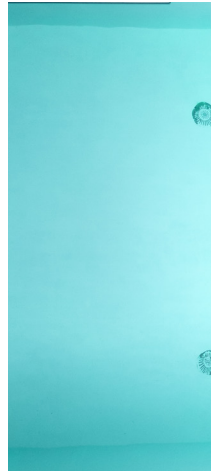

Le Paul Gauguin

The 165 suites and staterooms of *Le Paul Gauguin* all benefit from exterior views and are tastefully furnished and decorated.

The use of fine materials such as expensive woods and tiki design elements pays homage to Polynesian culture and combines elegantly with bright pop art colours. The atmosphere on board is suffused with its unique style, and permeates into the cruise guests. Result: the ambiance is relaxed and easy going!





1. The Algotherm Spa, for treatments and massages based on marine cosmetics
2. The swimming pool area, for relaxing in the sunshine, also features a bar
3. The Grill restaurant, on deck 8
4. L'Étoile gastronomic restaurant
5. The lounge-bar La Palette, open to the outside

6. Le Paul Gauguin
7. GS Grand Suite
8. The Owner's Suite 701
9. C balcony stateroom

Amenities

- Queen-size or king-size bed. In some staterooms the bed can convert to two single beds. Some staterooms also have a sofa bed.
- Minibar
- 110 V/220 V electrical sockets
- Flat-screen TV, CD/DVD player
- Telephone
- Safe
- Individual airconditioning
- Marble bathroom with bathtub (except seven staterooms with shower only)
- Algotherm toiletries and hairdryer
- 24-hour service
- Butler service for the Owner's Suites, the GS Grand Suites, A and B Veranda Suites and Staterooms
- Free Wi-Fi access*

**Depending on the navigation areas, the Wi-Fi may not be accessible for reasons beyond our control.*

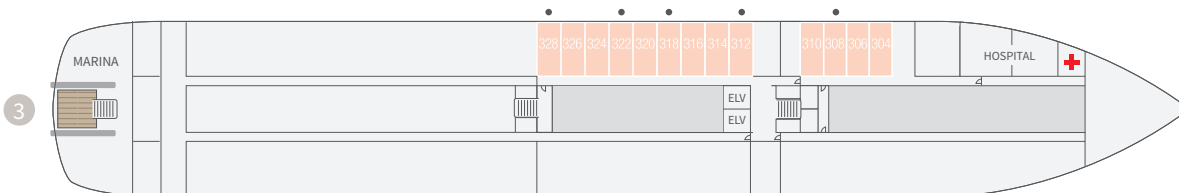
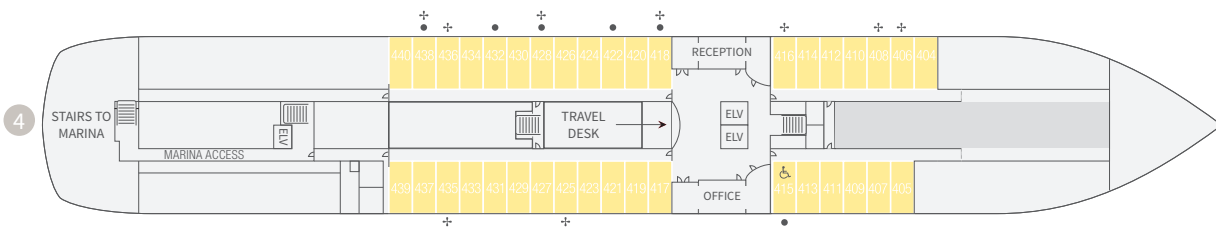
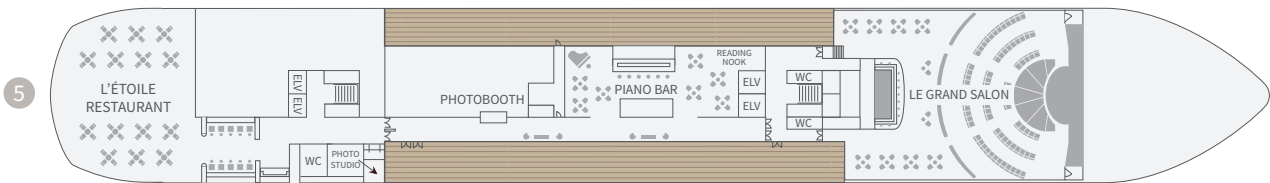
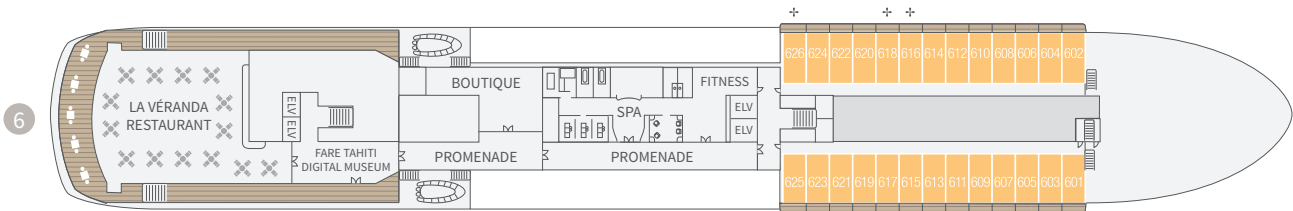
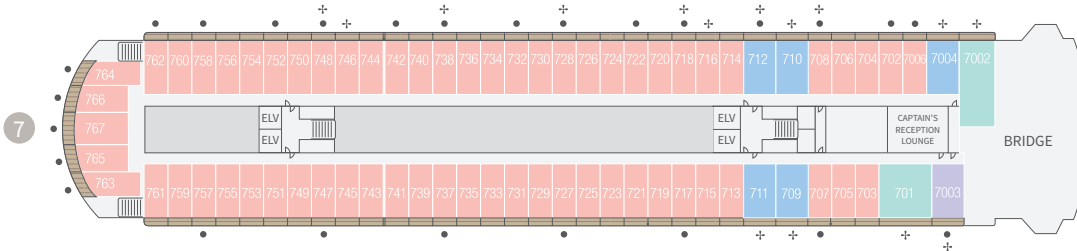
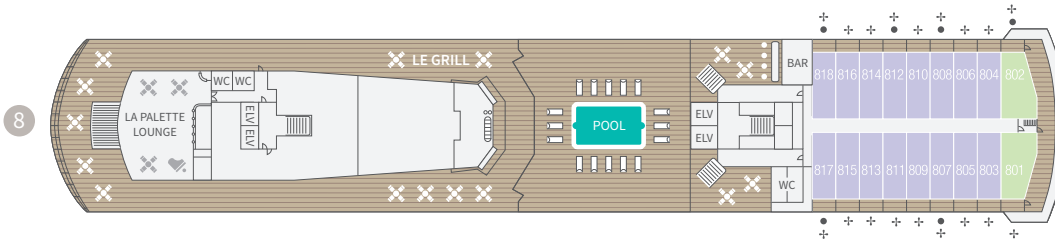
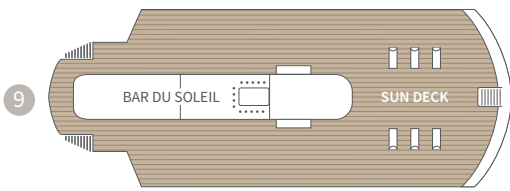

- OS Owner's Suites
Deck 7 (2)
- GS Grand Suites
Deck 8 (2)
- A Veranda Suites
Deck 7 (5)
- B Veranda Staterooms
Deck 8 (16)
- C Staterooms with balcony
Deck 7 (63)
- D Staterooms with balcony
Deck 6 (26)
- E Window Staterooms
Deck 4 (37)
- F Porthole Staterooms
Deck 3 (13)

- Denotes stateroom with two twin beds that convert to a large double bed.
- ⊕ Denotes stateroom with triple occupancy.
- ♿ Stateroom 415 is wheelchair accessible.

The sofa beds are slightly smaller than the standard twin beds.
Suites and staterooms range from 200 to 588 square feet.
This measurement includes balconies and verandas in categories D and above.

Discover your stateroom

OWNER'S SUITE 701

(42 sq.m/457 sq.ft + 7 sq.m/77 sq.ft veranda)

The bathroom boasts a separate shower and a dressing area.

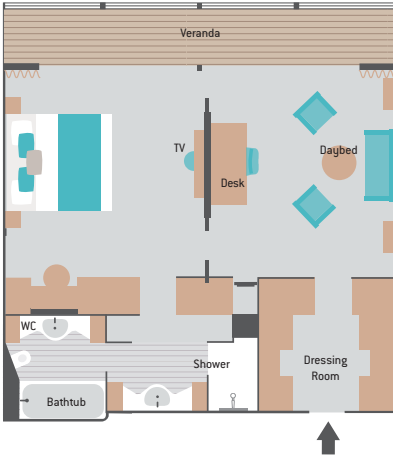

OWNER'S SUITE 7002

(49 sq.m/531 sq.ft + 5 sq.m/57 sq.ft veranda)

The bathroom boasts a bathtub and a dressing area.

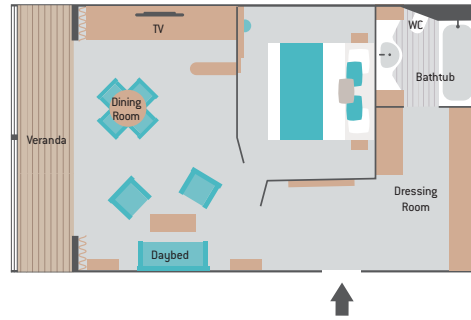

GS GRAND SUITE

(30 sq.m/332 sq.ft + 18 sq.m/197 sq.ft veranda)

Two suites available: the Paul Gauguin Suite (801) and the Flora Tristan Suite (802).

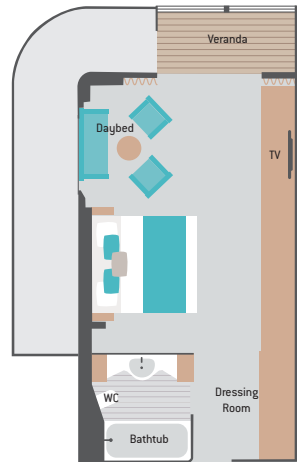

A VERANDA SUITE

(28 sq.m/300 sq.ft + 5 sq.m/58 sq.ft veranda)

Suites available: Tahiti Suite (709), Pont-Aven Suite (710), Atuona Suite (711), Arles Suite (712).

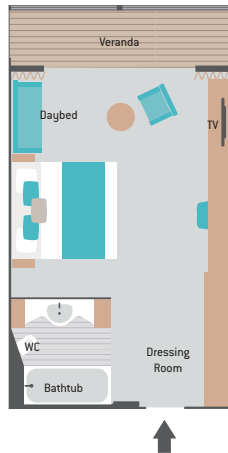

B VERANDA STATEROOM

(24 sq.m/249 sq.ft + 5 sq.m/56 sq.ft veranda)

Cabin 7003 has a shower cubicle and a double bed.

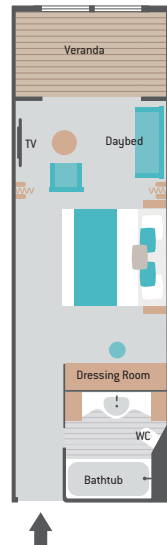

C BALCONY STATEROOM

(19 sq.m/202 sq.ft + 3 sq.m/37 sq.ft balcony)

Balcony Staterooms 708, 716, 718, 728, 738, 746 and 748 can accommodate a guest in a sofa bed.

Stateroom 7006 features a very small bathroom with shower only. Staterooms 763, 764, 765, 766 and 767 vary in size and feature shower stall with no tub.

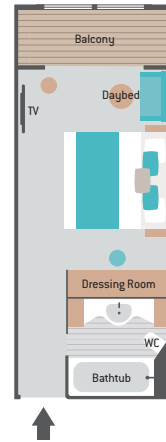

D BALCONY STATEROOM

(19 sq.m/202 sq.ft + 3 sq.m/37 sq.ft balcony)

The following Balcony Staterooms can accommodate a guest in a sofa bed: 616, 618 and 626.

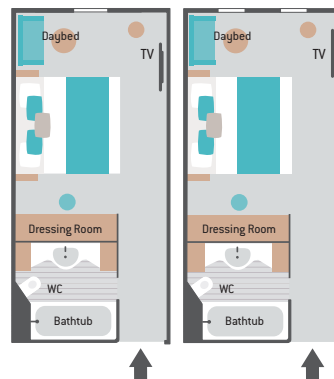
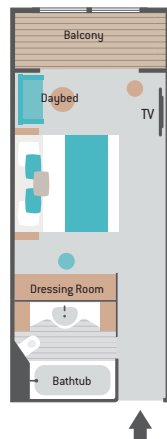

E WINDOW STATEROOM F PORTHOLE STATEROOM

(19 sq.m/200 sq.ft)

The following Window Staterooms can accommodate a guest in a sofa bed: 406, 408, 416, 418, 425, 428, 435, 436 and 438.

Explore
Le Paul Gauguin





Formalities

For all voyages

Passport valid for six (6) months after your return date. You are strongly advised to have at least two blank pages without any stamp in your passport. A page with ink marks or stamps (even small ones) cannot be considered a blank page. Passengers who deviate from the proposed embarkation and disembarkation programme must always check with the relevant authorities to find out about the customs formalities required for their trip.

Important information

Visas: before departure, you are advised to check that your visa's validity period matches the duration and dates of the stay requested, or you may encounter some unpleasant consequences if there is any non-compliance with the authorised duration of stay.

Conditions for entering Polynesia: to see the latest entry and stay conditions for Tahiti and its surrounding islands regarding Covid, please check the Tahiti Tourism website: <https://tahititourisme.com.au/en-au/>

Health: if you are undergoing medical treatment, do not forget your prescription. You are advised to contact a healthcare professional well in advance of your departure for any medical advice about your trip.

Specific formalities

Polynesia and South Pacific islands - *LE PAUL GAUGUIN*

PAPEETE • LAUTOKA and LAUTOKA • PAPEETE voyages

Fiji: for the voyage from Papeete to Lautoka, entry formalities to Fiji will be carried out on board. For the voyage from Lautoka to Papeete, you will receive an 'Arrival in Fiji' letter in English with your travel documents to present on arrival at Nadi airport.

Pricing

All advertised pricing is per person, based on twin share including port taxes and charges. Pricing is correct as of 11 April 2024 and is subject to change without notice. For single-occupancy rates, please contact us.

- (1) Tahiti & the Society Islands: Departing 6 April 2024 - Category E Window Stateroom
- (2) Pearls of the Society Islands: Departing 4 May 2024 - Category E Window Stateroom
- (3) Society Islands & the Tuamotus: Departing 24 January 2024 - Category E Window Stateroom
- (4) Cook Islands & Society Islands: Departing 24 February 2024 - Category E Window Stateroom
- (5) Marquesas, Tuamotus & Society Islands: Departing 21 December 2024 - Category E Window Stateroom
- (6) Marquesas in depth, Tuamotus & Society Islands: Departing 3 August 2024 - Category E Window Stateroom
- (7) Fiji, Tonga, Cook Islands & Society Islands: Departing 10 November 2024 - Category E Window Stateroom



Discover the general conditions of sale by scanning this QR code.

Paul Gauguin CRUISES

Information & reservations

1800 878 671 (AUS) | 0800 854 777 (NZ)

paulgauguin.aus@ponant.com

au.ponant.com/paul-gauguin

Follow us on social media



facebook.com/PGCruises



[@paulgauguincruises](https://instagram.com/@paulgauguincruises)



[@paulgauguin](https://twitter.com/@paulgauguin)



[@pgcruises](https://youtube.com/@pgcruises)



Lower Ground Floor, 165 Walker Street, North Sydney NSW 2060, Australia

au.ponant.com

ABN 35 166 676 517